



Forward Thinking. High Achieving.

LOWELL ELEMENTARY SCHOOL

Our proposal addresses areas of critical need, including ADA compliance, adequate classroom space, optimum safety, consistent classroom temperatures, accessible bathrooms and up-to-date infrastructure.



A systemwide initiative to develop schools that work smarter for our students.

MEET YOUR SMART SCHOOLS TEAM

The Lowell Elementary School team put months into this process. We appreciate the input from students, parents, faculty, neighbors and the MCPS board. If you have questions or would like to get involved, we encourage you to visit www.mcpsmt.org/lowell or contact Principal Brian Bessette at brbessette@mcps.k12.mt.us.

TEAM MEMBER CORE

Cole Amish, Student
Carole Addis, Teacher
Leslie Gallant, Classified
Brian Bessette, Administrator
Sally Painter, Parent
Heidi Wallace, Business/Community

TEAM MEMBER EXPANDED

Mila Champoux, Student
Mikaia Brown, Student
Kelly Schaefer, Teacher
Paige Ford, Teacher
Angela Knieper, Teacher
Alicia Bullock-Muth, Teacher
Jen Nave, Classified
Kathleen Ryan, Classified
Barb Gmiener, Classified
Evelyn Brown, Parent
Greg Hoover, Parent
Stephen Yoshimura, Parent
Leah Honsky, Business/Community
Kristy Luedecke, Business/
Community
Dave Strohmaier, Business/
Community

21ST CENTURY NEEDS

Lowell Elementary School, built 100 years ago, is outdated and a barrier to transforming classrooms into 21st-century learning environments. Undersized classrooms and aging infrastructure cannot keep up with increasing enrollments and technology demands. Safety and security continue to be a concern in a building that is not ADA compliant.

In order to address these key issues, Lowell plans a complete overhaul of the current facility with a new expansion to make Lowell a safe and secure 21st-century learning environment. (Lowell's second option is to start over with a brand new facility.)

EXPANDING LOWELL ELEMENTARY SCHOOL

Our proposed option involves overhauling and adding on to the current facility, with our only other choice being building a brand new facility. Our proposal moves students and teachers into the 21st century by removing the barriers the current facility experiences. The proposal achieves appropriate classroom space that allows for collaborative, project-based learning and exciting opportunities for the students and teachers into the future. When complete, Lowell will be a smarter school in many ways, including:

- Classrooms are large enough to support collaboration and project-based learning.
- Visible, safe and secure front office.
- Accessible bathrooms on all levels.
- Updated infrastructure supports all technology needs.
- Increased parking with improved safe drop-off and pickup zones.
- ADA compliance in all areas allowing accessibility schoolwide.
- A separate lunchroom allows flexibility in lunch schedules and the gym schedule.
- Updated heating and ventilation systems regulate room temperatures no matter the weather.



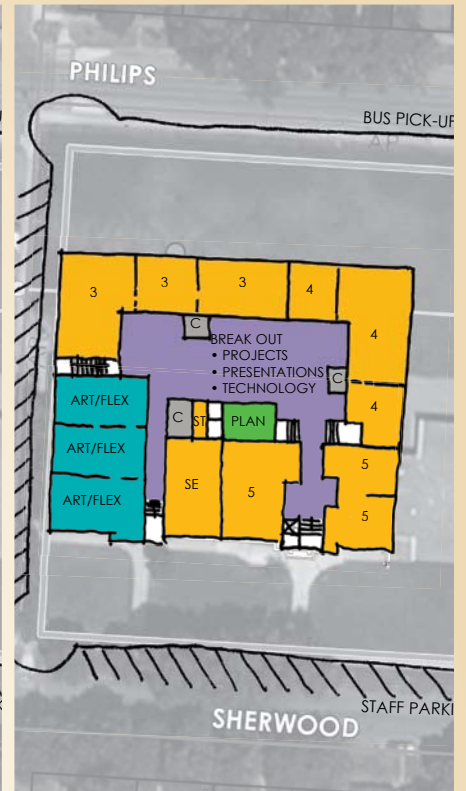
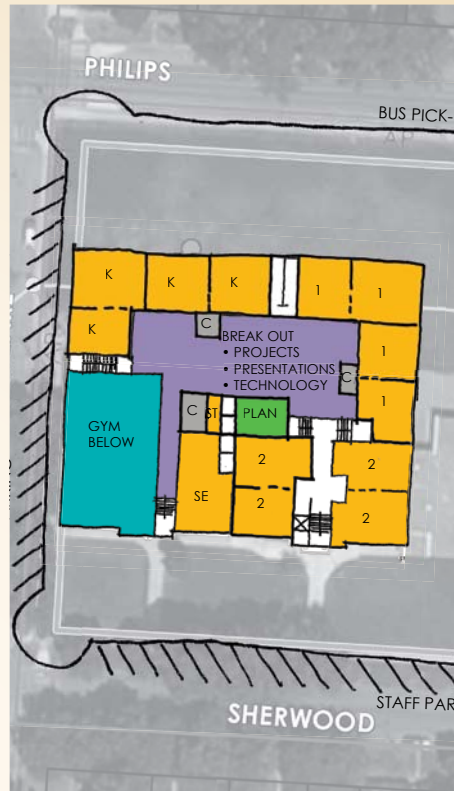
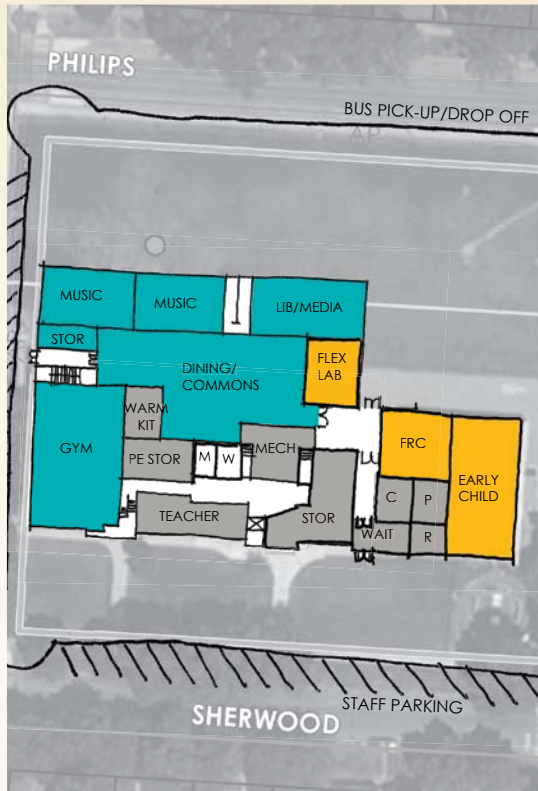

OUR TEAM'S RECOMMENDED OPTION

OPTION E-2 EXPAND:

- Remove existing modular classrooms.
- Expand school to north.
- Demolish east annex.

- Remodel existing school.
- Create parking street on Shakespeare and Sherwood.
- Create outdoor play and learning areas.

SECURITY

Modify facility to create obvious main entry, secure waiting area and ability to observe visitors approaching the building. Subdivide the building into secure zones with electronically activated door closers.

TECHNOLOGY

Develop high-speed/high-volume fiber optic distribution to breakout spaces for projects, presentations and technology in each learning community, enhanced with robust wireless and hard-wired access points.

ENVIRONMENT

Install barn doors and garage doors with quality acoustical materials between learning areas and breakout areas for projects, presentations and technology. Create small learning communities for teams of teachers and students that include traditional classrooms as well as important support spaces for 1:1 tutoring, small groups, planning centers, storage, etc.

FACILITIES STRATEGIC PLAN

Site Area: 4.37 acres

Parking spaces: None

Building Square Footage

Demolition: 3,018

Existing: 39,507

New: 28,000

Total Project Cost: \$10,741,336

Replacement Cost: \$11,395,797

Remaining Deferred Maintenance & Energy Project Costs: \$0

Rental / Lease / Sale Income: None

Current Enrollment: 284

Future Peak Enrollment: 329

Capacity: 450-500

Accessible Capacity: 450-500

Accessible / Permanent Capacity: 450-500

Costs include construction, demolition (where applicable), technology, furnishings, site development, design fees, and acquisition (where applicable). Contingency and escalation to January 2020.



NOW IS THE TIME TO INVEST IN SMARTER SCHOOLS

Education has never been more important than it is today. Our students face international competition for scholarships and jobs, and an increasing pace of change that impacts their futures. Yet, while the need for quality education continues to increase, our schools are physically in decline.

At Missoula County Public Schools, we realize that we must change if we're to keep up academically and economically as a community. That's why we launched Smart Schools 2020. Led by teams from each school, the initiative assesses needs by facility and prioritizes those needs in light of achieving our goals of a 21st Century Educational Culture and of being fiscally responsible.

By addressing schools now we prevent further deterioration of facilities, better prepare for population growth and ensure our students continue to get the educational opportunities they need to succeed in school and beyond.

THE SMART SCHOOLS PROCESS

SCHOOL CENTRIC:

Criteria and preferred options were established for each school by a team of teachers, administrators, students and parents from that school, along with members of the Missoula community.

COLLABORATIVE:

Alternatives were shared at public meetings at each school. In addition, surveys were sent out systemwide to vet priorities.

REALISTIC:

Team recommendations will be reviewed by the steering committee and the elected board of trustees before a bond measure is drafted.

PUBLIC:

Everyone is invited to review options and weigh in. Final support for the initiative will be determined by public election in November 2015.



To get involved, please visit www.mcpsmt.org/lowell or contact Principal Brian Bessette at brbessette@mcps.k12.mt.us.